

# CORE PIPE<sup>®</sup>

***Piping Solutions That Fit.<sup>®</sup>***

 **PICOR<sup>®</sup>**

 **TUBE LINE<sup>®</sup>**  
STAINLESS

 **TUBE TEC<sup>®</sup>**

 **BRITE LINE<sup>®</sup>**

## Large Diameter Industry Standard Slip On Catalog

Sizes 26" Through 96"  
All Dimensions in Inches

Please visit our website at:  
[www.corepipe.com](http://www.corepipe.com)

Please visit our E-Commerce website at:  
[www.shopcorepipe.com](http://www.shopcorepipe.com)



170 Tubeway Drive  
Carol Stream, IL 60188  
Phone 630-690-7000  
Fax 630-690-9701

301 Brown Avenue  
Sanford, FL 32771  
Phone 407-323-0940  
Fax 321-257-1005

**Class 125-150# Slip On (Industry Standard)**

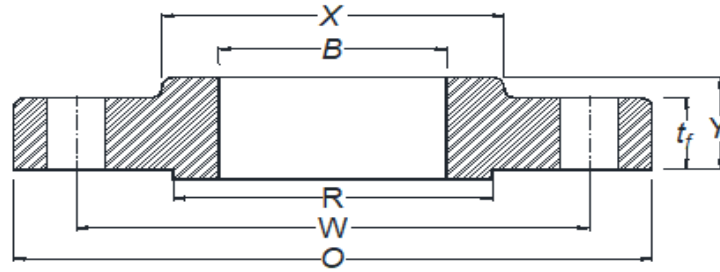

**SLIP ON FLANGE**

Nominal Pipe Size							Drilling	
	Outside Diameter of Flange, O	Minimum Thickness of Flange, t <sub>f</sub>	Length Through Hub, Y	Diameter of Hub, X	Diameter of Bore, B	Raised Face Diameter, R	Diameter of Bolt Circle, W	Bolt Hole Qty / Dia
26	34.25	2.000	3.375	28.500	26.19	29.500	31.75	24 / 1.38
28	36.50	2.062	3.438	30.750	28.19	31.500	34.00	28 / 1.38
30	38.75	2.125	3.500	32.750	30.19	33.750	36.00	28 / 1.38
32	41.75	2.250	3.625	35.000	32.19	36.000	38.50	28 / 1.62
34	43.75	2.312	3.688	37.000	34.19	38.000	40.50	32 / 1.62
36	46.00	2.375	3.750	39.250	36.19	40.250	42.75	32 / 1.62
38	48.75	2.375	3.750	41.750	38.19	42.250	45.25	32 / 1.62
40	50.75	2.500	3.875	43.750	40.19	44.250	47.25	36 / 1.62
42	53.00	2.625	4.000	46.000	42.19	47.000	49.50	36 / 1.62
44	55.25	2.625	4.000	48.000	44.19	49.000	51.75	40 / 1.62
46	57.25	2.688	4.062	50.000	46.19	51.000	53.75	40 / 1.62
48	59.50	2.750	4.125	52.250	48.19	53.500	56.00	44 / 1.62
50	61.75	2.750	4.125	54.250	50.19	55.500	58.25	44 / 1.88
52	64.00	2.875	4.250	56.500	52.19	57.500	60.50	44 / 1.88
54	66.25	3.000	4.375	58.750	54.19	59.750	62.75	44 / 1.88
60	73.00	3.125	4.500	65.250	60.19	66.000	69.25	52 / 1.88
66	80.00	3.375	4.875	71.500	66.19	73.000	76.00	52 / 1.88
72	86.50	3.500	5.000	78.500	72.19	79.500	82.50	60 / 1.88
78	93.00	3.875	5.375	84.500	78.19	86.000	89.00	64 / 2.13
84	99.75	3.875	5.375	90.500	84.19	92.500	95.50	64 / 2.12
90	106.50	4.250	5.750	96.750	90.19	99.000	102.00	68 / 2.44
96	113.25	4.250	5.750	102.750	96.19	105.500	108.50	68 / 2.38

Note: These are also commonly referred to as 150# . Can be furnished with a raised face ( RF ) or flat face ( FF )  
 These flanges have the same outside diameter (O.D.) and drilling as B16.1 Class 125 # Cast Iron Flanges.  
 Dimensions and Pressure Ratings are derived from AWWA C207 Class E  
 Pressure Rating at atmospheric temperature is 275 psi