

CORE PIPE[®]

Piping Solutions That Fit.[®]

 **PICOR**[®]

 **TUBE LINE**[®]
STAINLESS

 **TUBE TEC**[®]

 **BRITE LINE**[®]

Long Tangent and Belled End Catalog

All Dimensions in Inches

Please visit our website at:
www.corepipe.com

Please visit our E-Commerce website at:
www.shopcorepipe.com



170 Tubeway Drive
Carol Stream, IL 60188
Phone 630-690-7000
Fax 630-690-9701

301 Brown Avenue
Sanford, FL 32771
Phone 407-323-0940
Fax 321-257-1005

90LR Long Tangent and Belled End

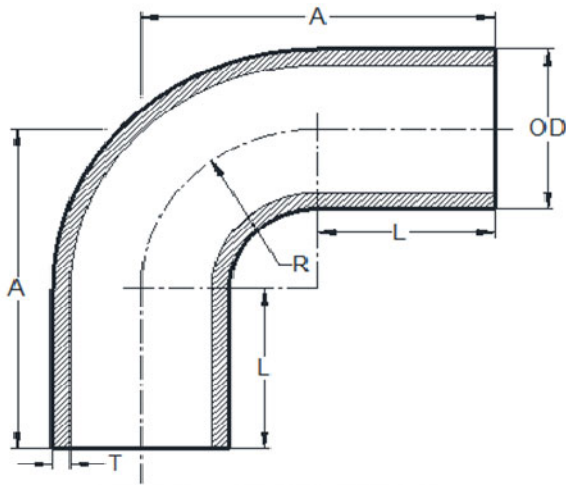

LONG TANGENT 90°LR ELBOW

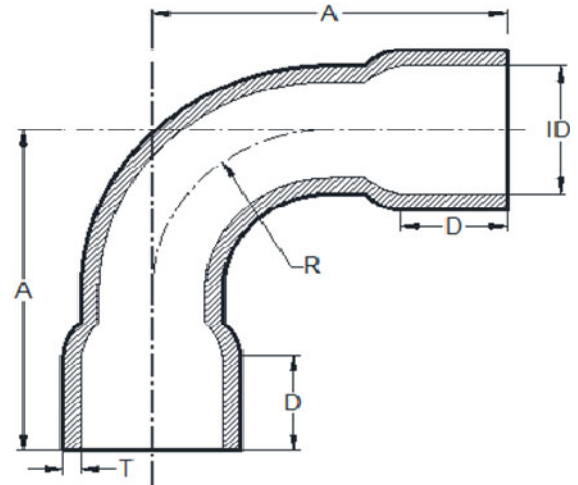

BELLED END 90°LR ELBOW

Nominal Pipe Size	Long Tangent Dimensions			Belled End Dimensions			Radius, R	Schedule 5S	Schedule 10S
	Outside Diameter, OD	Center to End, A	Tangent Length, L	Inside Diameter, ID	Center to End, A	Bell Depth, D		Nominal Wall, T	Nominal Wall, T
½	0.840	2.750	1.250	0.851	2.688	0.375	1.500	0.065	0.083
¾	1.050	2.625	1.125	1.061	2.563	0.625	1.500	0.065	0.083
1	1.315	2.875	1.375	1.326	2.813	0.625	1.500	0.065	0.109
1 ¼	1.660	3.125	1.250	1.676	3.063	0.750	1.875	0.065	0.109
1 ½	1.900	3.500	1.250	1.918	3.438	0.750	2.250	0.065	0.109
2	2.375	4.500	1.500	2.393	4.438	1.000	3.000	0.065	0.109
2 ½	2.875	5.000	1.250	2.895	4.938	1.000	3.750	0.083	0.120
3	3.500	6.500	2.000	3.525	6.438	1.000	4.500	0.083	0.120
4	4.500	8.250	2.250	4.525	8.188	1.000	6.000	0.083	0.120
5	5.563	9.750	2.250	5.563	9.688	1.000	7.500	0.109	0.134
6	6.625	11.250	2.250	6.650	11.188	1.000	9.000	0.109	0.134
8	8.625	14.250	2.250	8.660	14.188	1.000	12.000	0.109	0.134

90SR Long Tangent and Belled End

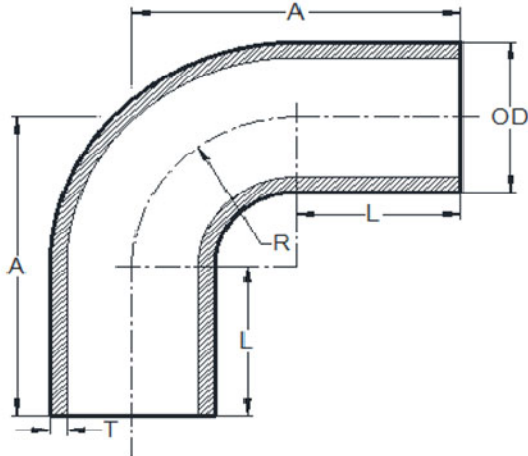

LONG TANGENT 90° SR ELBOW

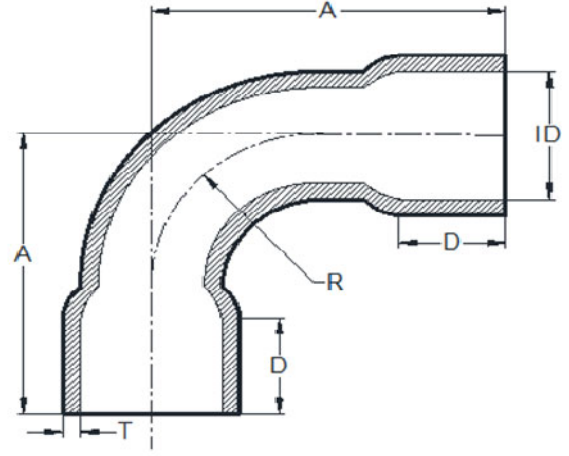

BELLED END 90° SR ELBOW

Nominal Pipe Size	Long Tangent Dimensions			Belled End Dimensions			Radius, R	Schedule 5S	Schedule 10S
	Outside Diameter, OD	Center to End, A	Tangent Length, L	Inside Diameter, ID	Center to End, A	Bell Depth, D		Nominal Wall, T	Nominal Wall, T
1	1.315	2.750	1.750	1.326	2.750	0.625	1.000	0.065	0.109
1 ¼	1.660	3.000	1.750	1.676	3.000	0.750	1.250	0.065	0.109
1 ½	1.900	3.250	1.750	1.918	3.250	0.750	1.500	0.065	0.109
2	2.375	3.750	1.750	2.393	3.750	1.000	2.000	0.065	0.109
2 ½	2.875	4.250	1.750	2.895	4.250	1.000	2.500	0.083	0.120
3	3.500	4.750	1.750	3.525	4.750	1.000	3.000	0.083	0.120
4	4.500	5.000	1.000	4.525	5.000	1.000	4.000	0.083	0.120
5	5.563	6.000	1.000	5.563	6.000	1.000	5.000	0.109	0.134
6	6.625	7.000	1.000	6.650	7.000	1.000	6.000	0.109	0.134

45LR Long Tangent and Belled End

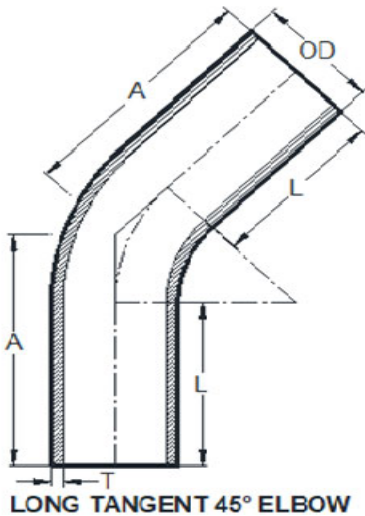

LONG TANGENT 45° ELBOW

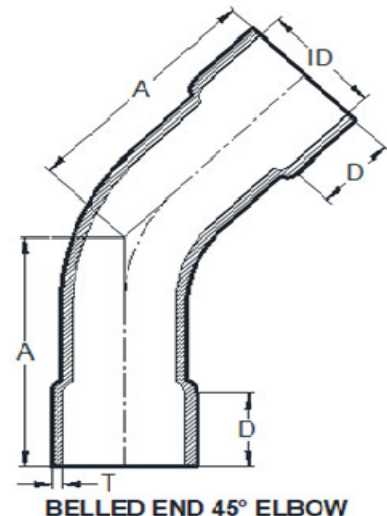

BELLED END 45° ELBOW

Nominal Pipe Size	Long Tangent Dimensions			Belled End Dimensions			Schedule 5S	Schedule 10S
	Outside Diameter, OD	Center to End, A	Tangent Length, L	Inside Diameter, ID	Center to End, A	Bell Depth, D	Nominal Wall, T	Nominal Wall, T
½	0.840	1.875	1.250	0.851	1.875	0.375	0.065	0.083
¾	1.050	1.937	1.250	1.061	1.937	0.625	0.065	0.083
1	1.315	2.000	1.375	1.326	2.000	0.625	0.065	0.109
1 ¼	1.660	2.000	1.250	1.676	2.000	0.750	0.065	0.109
1 ½	1.900	2.187	1.250	1.918	2.187	0.750	0.065	0.109
2	2.375	2.750	1.500	2.393	2.750	1.000	0.065	0.109
2 ½	2.875	2.812	1.250	2.895	2.812	1.000	0.083	0.120
3	3.500	3.875	2.000	3.525	3.875	1.000	0.083	0.120
4	4.500	4.750	2.250	4.525	4.750	1.000	0.083	0.120
5	5.563	5.370	2.250	5.563	5.370	1.000	0.109	0.134
6	6.625	6.000	2.250	6.650	6.000	1.000	0.109	0.134
8	8.625	7.250	2.250	8.660	7.250	1.000	0.109	0.148

Straight Tee Long Tangent and Belled End

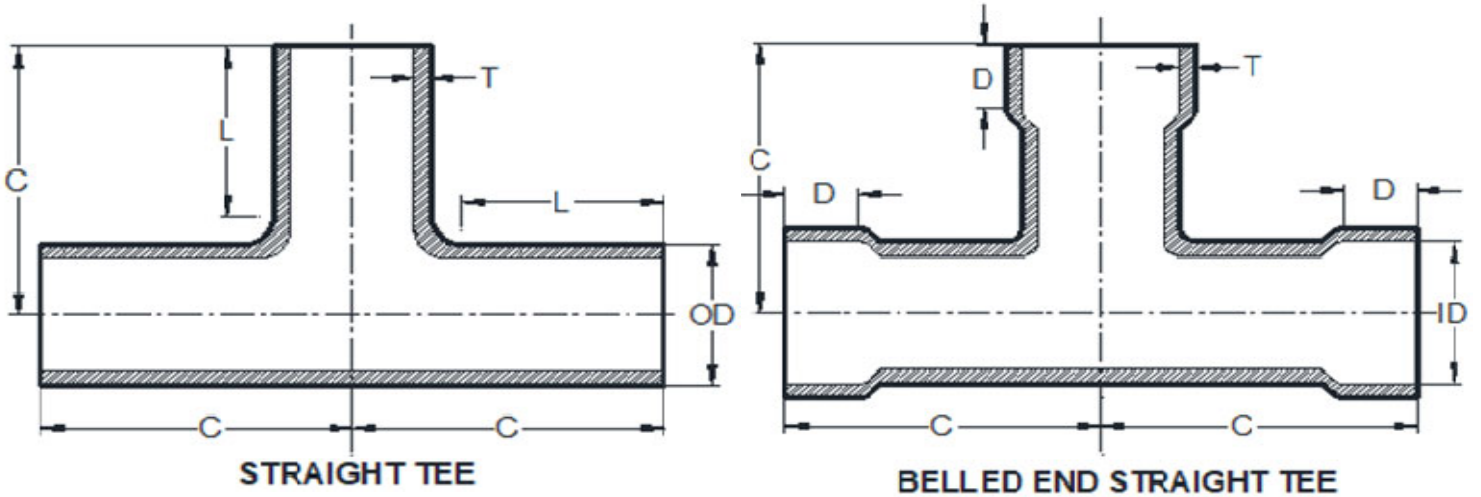

Nominal Pipe Size	Long Tangent Dimensions			Belled End Dimensions			Schedule 5S	Schedule 10S
	Outside Diameter, OD	Center to End, A	Tangent Length, L	Inside Diameter, ID	Center to End, A	Bell Depth, D	Nominal Wall, T	Nominal Wall, T
½	0.840	2.375	1.250	0.851	2.313	0.375	0.065	0.083
¾	1.050	2.625	1.250	1.061	2.563	0.625	0.065	0.083
1	1.315	2.875	1.250	1.326	2.813	0.625	0.065	0.109
1 ¼	1.660	3.125	1.500	1.676	3.063	0.750	0.065	0.109
1 ½	1.900	3.375	1.500	1.918	3.313	0.750	0.065	0.109
2	2.375	4.000	1.500	2.393	3.938	1.000	0.065	0.109
2 ½	2.875	4.625	1.500	2.895	4.563	1.000	0.083	0.120
3	3.500	5.000	2.000	3.525	4.938	1.000	0.083	0.120
4	4.500	5.750	2.000	4.525	5.688	1.000	0.083	0.120
5	5.563	6.750		5.563		1.000	0.109	0.134
6	6.625	7.875	2.250	6.650	7.812	1.000	0.109	0.134
8	8.625	9.250		8.660		1.000	0.109	0.148

Straight Cross Long Tangent and Belled End

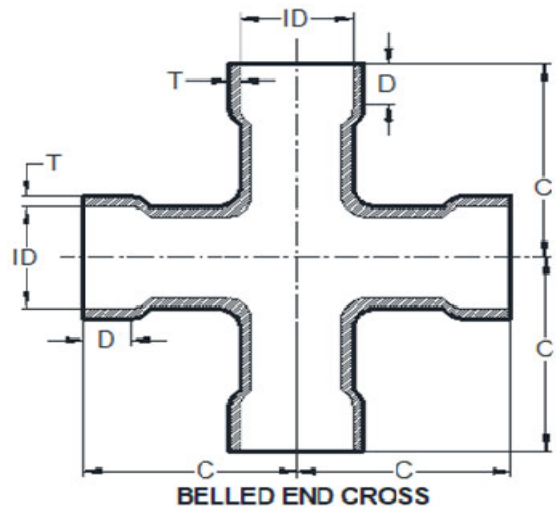
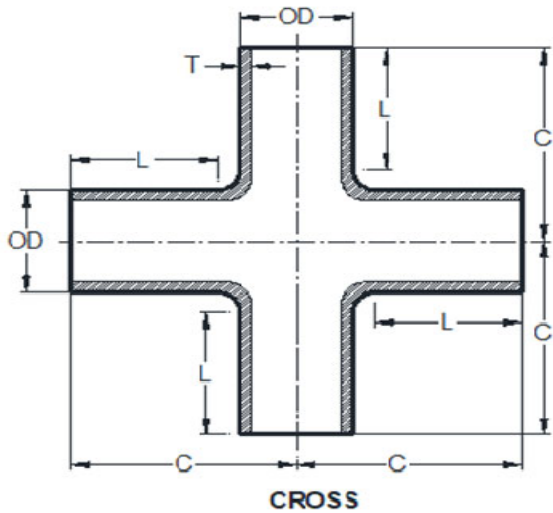

Nominal Pipe Size	Long Tangent Dimensions			Belled End Dimensions			Schedule 5S	Schedule 10S
	Outside Diameter, OD	Center to End, A	Tangent Length, L	Inside Diameter, ID	Center to End, A	Bell Depth D	Nominal Wall, T	Nominal Wall, T
½	0.840	2.375	1.250	0.840	2.313	0.375	0.065	0.083
¾	1.050	2.625	1.250	1.050	2.563	0.625	0.065	0.083
1	1.315	2.875	1.250	1.315	2.813	0.625	0.065	0.109
1 ¼	1.660	3.125	1.500	1.660	3.063	0.750	0.065	0.109
1 ½	1.900	3.375	1.500	1.900	3.313	0.750	0.065	0.109
2	2.375	4.000	1.500	2.375	3.938	1.000	0.065	0.109
2 ½	2.875	4.625	1.500	2.875	4.563	1.000	0.083	0.120
3	3.500	5.000	2.000	3.500	4.938	1.000	0.083	0.120
4	4.500	5.750	2.000	4.500	5.688	1.000	0.083	0.120
5	5.563	6.875		5.563		1.000	0.109	0.134
6	6.625	7.875	2.250	6.625	7.812	1.000	0.109	0.134
8	8.625	9.250		8.625		1.000	0.109	0.148

Reducing Outlet Crosses are available on special request.

Reducing Tee Long Tangent and Belled End

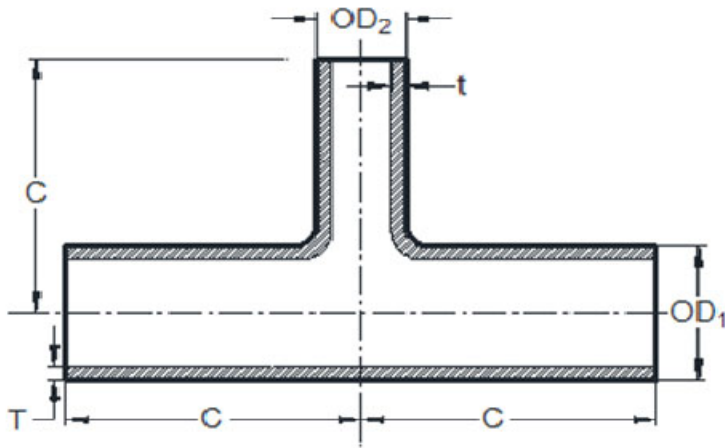

REDUCING TEE

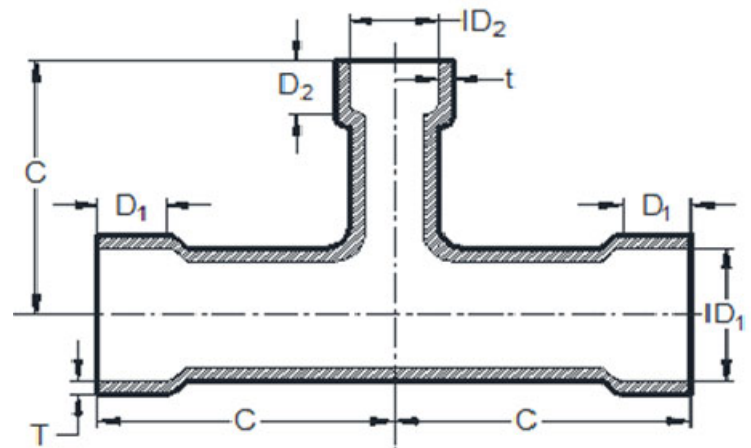

BELLED END REDUCING TEE

Nominal Pipe Size	Long Tangent Dimensions			Belled End Dimensions				Schedule 5S		Schedule 10S	
	Outside Dia., OD ₁	Outside Dia., OD ₂	Center to End, C	Inside Dia., ID ₁	Inside Dia., ID ₂	Bell Depth, D ₁	Bell Depth, D ₂	Nominal Wall, T	Nominal Wall, t	Nominal Wall, T	Nominal Wall, t
¾ x ½	1.050	0.840	2.625	1.050	0.840	0.625	0.375	0.065	0.065	0.083	0.083
1 x ½	1.315	0.840	2.875	1.315	0.840	0.625	0.375	0.065	0.065	0.109	0.083
1 x ¾	1.315	1.050	2.875	1.315	1.050	0.625	0.625	0.065	0.065	0.109	0.083
1 ¼ x ½	1.660	0.840	3.125	1.660	0.840	0.750	0.375	0.065	0.065	0.109	0.083
1 ¼ x ¾	1.660	1.050	3.125	1.660	1.050	0.750	0.625	0.065	0.065	0.109	0.083
1 ¼ x 1	1.660	1.315	3.125	1.660	1.315	0.750	0.625	0.065	0.065	0.109	0.109
1 ½ x ½	1.900	0.840	3.375	1.900	0.840	0.750	0.375	0.065	0.065	0.109	0.083
1 ½ x ¾	1.900	1.050	3.375	1.900	1.050	0.750	0.625	0.065	0.065	0.109	0.083
1 ½ x 1	1.900	1.315	3.375	1.900	1.315	0.750	0.625	0.065	0.065	0.109	0.109
1 ½ x 1 ¼	1.900	1.660	3.375	1.900	1.660	0.750	0.750	0.065	0.065	0.109	0.109
2 x ½	2.375	0.840	4.000	2.375	0.840	1.000	0.375	0.065	0.065	0.109	0.083
2 x ¾	2.375	1.050	4.000	2.375	1.050	1.000	0.625	0.065	0.065	0.109	0.083
2 x 1	2.375	1.315	4.000	2.375	1.315	1.000	0.625	0.065	0.065	0.109	0.109
2 x 1 ¼	2.375	1.660	4.000	2.375	1.660	1.000	0.750	0.065	0.065	0.109	0.109
2 x 1 ½	2.375	1.900	4.000	2.375	1.900	1.000	0.750	0.065	0.065	0.109	0.109
2 ½ x ½	2.875	0.840	4.625	2.875	0.840	1.000	0.375	0.083	0.065	0.120	0.083
2 ½ x ¾	2.875	1.050	4.625	2.875	1.050	1.000	0.625	0.083	0.065	0.120	0.083
2 ½ x 1	2.875	1.315	4.625	2.875	1.315	1.000	0.625	0.083	0.065	0.120	0.109
2 ½ x 1 ¼	2.875	1.660	4.625	2.875	1.660	1.000	0.750	0.083	0.065	0.120	0.109
2 ½ x 1 ½	2.875	1.900	4.625	2.875	1.900	1.000	0.750	0.083	0.065	0.120	0.109
2 ½ x 2	2.875	2.375	4.625	2.875	2.375	1.000	1.000	0.083	0.065	0.120	0.109
3 x ½	3.500	0.840	5.000	3.500	0.840	1.000	0.375	0.083	0.065	0.120	0.083
3 x ¾	3.500	1.050	5.000	3.500	1.050	1.000	0.625	0.083	0.065	0.120	0.083
3 x 1	3.500	1.315	5.000	3.500	1.315	1.000	0.625	0.083	0.065	0.120	0.109

Reducing Tee Long Tangent and Belled End

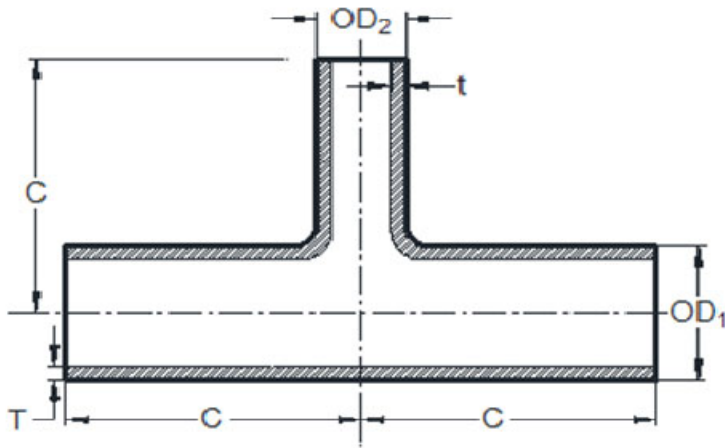

REDUCING TEE

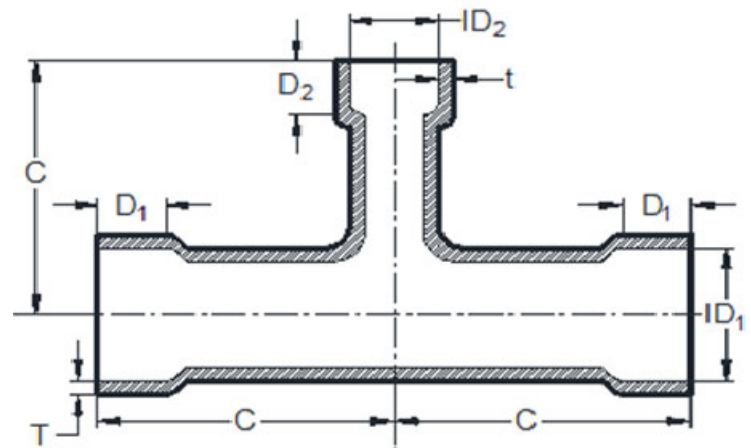

BELLED END REDUCING TEE

Nominal Pipe Size	Long Tangent Dimensions			Belled End Dimensions				Schedule 5S		Schedule 10S	
	Outside Dia., OD ₁	Outside Dia., OD ₂	Center to End, C	Inside Dia., ID ₁	Inside Dia., ID ₂	Bell Depth, D ₁	Bell Depth, D ₂	Nominal Wall, T	Nominal Wall, t	Nominal Wall, T	Nominal Wall, t
3 x 1 ¼	3.500	1.660	5.000	3.500	1.660	1.000	0.750	0.083	0.065	0.120	0.109
3 x 1 ½	3.500	1.900	5.000	3.500	1.900	1.000	0.750	0.083	0.065	0.120	0.109
3 x 2	3.500	2.375	5.000	3.500	2.375	1.000	1.000	0.083	0.065	0.120	0.109
3 x 2 ½	3.500	2.875	5.000	3.500	2.875	1.000	1.000	0.083	0.065	0.120	0.120
4 x ½	4.500	0.840	5.750	4.500	0.840	1.000	0.375	0.083	0.065	0.120	0.083
4 x ¾	4.500	1.050	5.750	4.500	1.050	1.000	0.625	0.083	0.065	0.120	0.083
4 x 1	4.500	1.315	5.750	4.500	1.315	1.000	0.625	0.083	0.065	0.120	0.109
4 x 1 ¼	4.500	1.660	5.750	4.500	1.660	1.000	0.750	0.083	0.065	0.120	0.109
4 x 1 ½	4.500	1.900	5.750	4.500	1.900	1.000	0.750	0.083	0.065	0.120	0.109
4 x 2	4.500	2.375	5.750	4.500	2.375	1.000	0.750	0.083	0.065	0.120	0.109
4 x 2 ½	4.500	2.875	5.750	4.500	2.875	1.000	0.750	0.083	0.083	0.120	0.120
4 x 3	4.500	3.500	5.750	4.500	3.500	1.000	0.750	0.083	0.083	0.120	0.120
5 x ½	5.563	0.840	6.875	5.563	0.840	1.000	0.375	0.109	0.065	0.134	0.083
5 x ¾	5.563	1.050	6.875	5.563	1.050	1.000	0.625	0.109	0.065	0.134	0.083
5 x 1	5.563	1.315	6.875	5.563	1.315	1.000	0.625	0.109	0.065	0.134	0.109
5 x 1 ¼	5.563	1.660	6.875	5.563	1.660	1.000	0.750	0.109	0.065	0.134	0.109
5 x 1 ½	5.563	1.900	6.875	5.563	1.900	1.000	0.750	0.109	0.065	0.134	0.109
5 x 2	5.563	2.375	6.875	5.563	2.375	1.000	1.000	0.109	0.065	0.134	0.109
5 x 2 ½	5.563	2.875	6.875	5.563	2.875	1.000	1.000	0.109	0.083	0.134	0.120
5 x 3	5.563	3.500	6.875	5.563	3.500	1.000	1.000	0.109	0.083	0.134	0.120
5 x 4	5.563	4.500	6.875	5.563	4.500	1.000	1.000	0.109	0.083	0.134	0.120
6 x ½	6.625	0.840	7.875	6.625	0.840	1.000	0.375	0.109	0.065	0.134	0.083
6 x ¾	6.625	1.050	7.875	6.625	1.050	1.000	0.625	0.109	0.065	0.134	0.083
6 x 1	6.625	1.315	7.875	6.625	1.315	1.000	0.625	0.109	0.065	0.134	0.109

Reducing Tee Long Tangent and Belled End

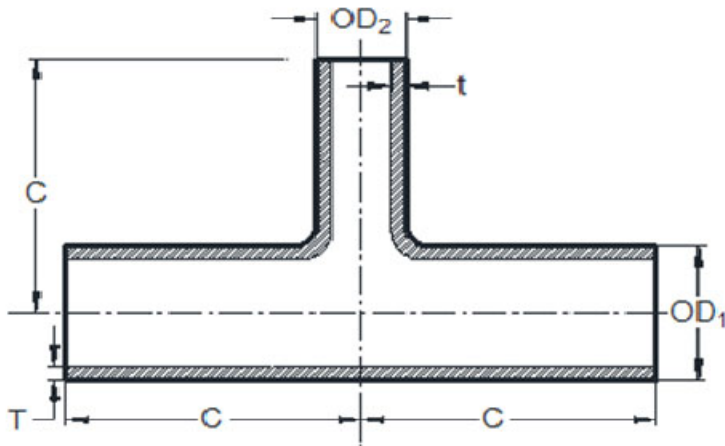

REDUCING TEE

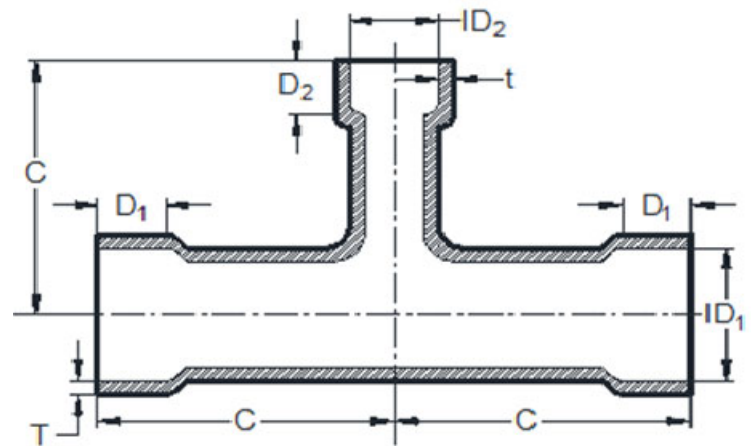

BELLED END REDUCING TEE

Nominal Pipe Size	Long Tangent Dimensions			Belled End Dimensions				Schedule 5S		Schedule 10S	
	Outside Dia., OD ₁	Outside Dia., OD ₂	Center to End, C	Inside Dia., ID ₁	Inside Dia., ID ₂	Bell Depth, D ₁	Bell Depth, D ₂	Nominal Wall, T	Nominal Wall, t	Nominal Wall, T	Nominal Wall, t
6 x 1 ¼	6.625	1.660	7.875	6.625	1.660	1.000	0.750	0.109	0.065	0.134	0.109
6 x 1 ½	6.625	1.900	7.875	6.625	1.900	1.000	0.750	0.109	0.065	0.134	0.109
6 x 2	6.625	2.375	7.875	6.625	2.375	1.000	1.000	0.109	0.065	0.134	0.109
6 x 2 ½	6.625	2.875	7.875	6.625	2.875	1.000	1.000	0.109	0.083	0.134	0.120
6 x 3	6.625	3.500	7.875	6.625	3.500	1.000	1.000	0.109	0.083	0.134	0.120
6 x 4	6.625	4.500	7.875	6.625	4.500	1.000	1.000	0.109	0.083	0.134	0.120
6 x 5	6.625	5.563	7.875	6.625	5.563	1.000	1.000	0.109	0.109	0.134	0.134
8 x ½	8.620	0.840	9.250	8.620	0.840	1.000	0.375	0.109	0.065	0.148	0.083
8 x ¾	8.620	1.050	9.250	8.620	1.050	1.000	0.625	0.109	0.065	0.148	0.083
8 x 1	8.620	1.315	9.250	8.620	1.315	1.000	0.625	0.109	0.065	0.148	0.109
8 x 1 ¼	8.620	1.660	9.250	8.620	1.660	1.000	0.750	0.109	0.065	0.148	0.109
8 x 1 ½	8.620	1.900	9.250	8.620	1.900	1.000	0.750	0.109	0.065	0.148	0.109
8 x 2	8.620	2.375	9.250	8.620	2.375	1.000	1.000	0.109	0.065	0.148	0.109
8 x 2 ½	8.620	2.875	9.250	8.620	2.875	1.000	1.000	0.109	0.083	0.148	0.120
8 x 3	8.620	3.500	9.250	8.620	3.500	1.000	1.000	0.109	0.083	0.148	0.120
8 x 4	8.620	4.500	9.250	8.620	4.500	1.000	1.000	0.109	0.083	0.148	0.120
8 x 5	8.620	5.563	9.250	8.620	5.563	1.000	1.000	0.109	0.109	0.148	0.134
8 x 6	8.620	6.625	9.250	8.620	6.625	1.000	1.000	0.109	0.109	0.148	0.134

Concentric Reducer Long Tangent and Belled End

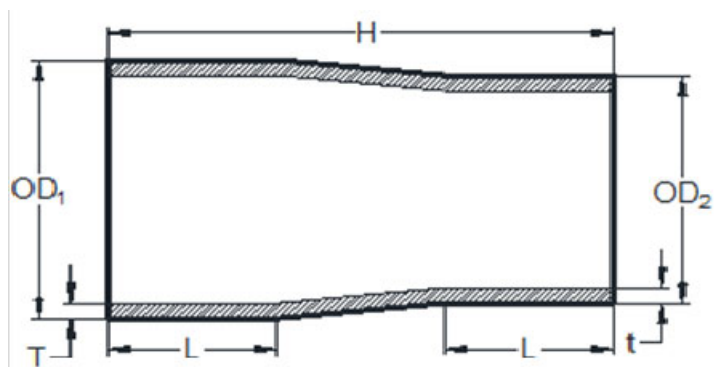

CONCENTRIC REDUCER

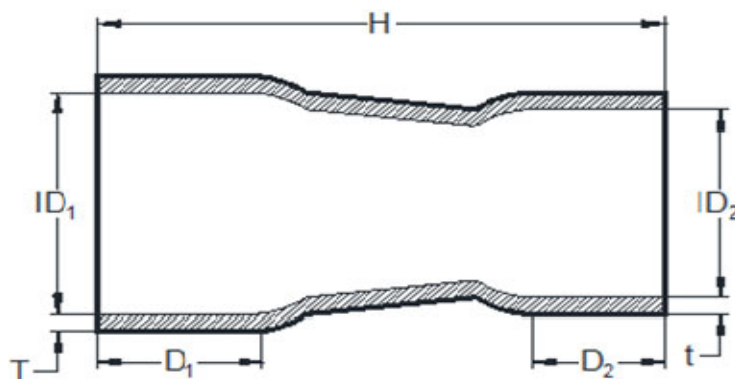

BELLED END CONCENTRIC REDUCER

Nominal Pipe Size	Long Tangent Dimensions				Belled End Dimensions				Schedule 5S		Schedule 10S	
	Outside Dia., OD ₁	Outside Dia., OD ₂	Tang., L	Length, H	Inside Dia., ID ₁	Inside Dia., ID ₂	Bell Depth, D ₁	Bell Depth, D ₂	Nominal Wall, T	Nominal Wall, t	Nominal Wall, T	Nominal Wall, t
¾ x ½	1.050	0.840	0.688	3.375	1.050	0.840	0.625	0.375	0.065	0.065	0.083	0.083
1 x ½	1.315	0.840	0.750	3.375	1.315	0.840	0.625	0.375	0.065	0.065	0.109	0.083
1 x ¾	1.315	1.050	0.750	3.375	1.315	1.050	0.625	0.625	0.065	0.065	0.109	0.083
1 ¼ x ¾	1.660	1.050	0.875	3.375	1.660	1.050	0.750	0.625	0.065	0.065	0.109	0.083
1 ¼ x 1	1.660	1.315	0.875	3.375	1.660	1.315	0.750	0.625	0.065	0.065	0.109	0.109
1 ½ x ¾	1.900	1.050	1.000	3.375	1.900	1.050	0.750	0.625	0.065	0.065	0.109	0.083
1 ½ x 1	1.900	1.315	1.000	3.375	1.900	1.315	0.750	0.625	0.065	0.065	0.109	0.109
1 ½ x 1 ¼	1.900	1.660	1.000	3.375	1.900	1.660	0.750	0.750	0.065	0.065	0.109	0.109
2 x 1	2.375	1.315	1.063	3.375	2.375	1.315	1.000	0.625	0.065	0.065	0.109	0.109
2 x 1 ¼	2.375	1.660	1.063	3.375	2.375	1.660	1.000	0.750	0.065	0.065	0.109	0.109
2 x 1 ½	2.375	1.900	1.063	3.375	2.375	1.900	1.000	0.750	0.065	0.065	0.109	0.109
2 ½ x 1 ¼	2.875	1.660	1.188	5.000	2.875	1.660	1.000	0.750	0.083	0.065	0.120	0.109
2 ½ x 1 ½	2.875	1.900	1.188	5.000	2.875	1.900	1.000	0.750	0.083	0.065	0.120	0.109
2 ½ x 2	2.875	2.375	1.188	5.000	2.875	2.375	1.000	1.000	0.083	0.065	0.120	0.109
3 x 1 ¼	3.500	1.660	1.250	5.000	3.500	1.660	1.000	0.750	0.083	0.065	0.120	0.109
3 x 1 ½	3.500	1.900	1.250	5.000	3.500	1.900	1.000	0.750	0.083	0.065	0.120	0.109
3 x 2	3.500	2.375	1.250	5.000	3.500	2.375	1.000	1.000	0.083	0.065	0.120	0.109
3 x 2 ½	3.500	2.875	1.250	5.000	3.500	2.875	1.000	1.000	0.083	0.083	0.120	0.120
4 x 2	4.500	2.375	1.375	5.000	4.500	2.375	1.000	1.000	0.083	0.065	0.120	0.109
4 x 2 ½	4.500	2.875	1.375	5.000	4.500	2.875	1.000	1.000	0.083	0.083	0.120	0.120
4 x 3	4.500	3.500	1.375	5.000	4.500	3.500	1.000	1.000	0.083	0.083	0.120	0.120
6 x 2 ½	6.625	2.875	1.500	9.000	6.625	2.875	1.000	1.000	0.109	0.083	0.134	0.120
6 x 3	6.625	3.500	1.500	9.000	6.625	3.500	1.000	1.000	0.109	0.083	0.134	0.120

Concentric Reducer Long Tangent and Belled End

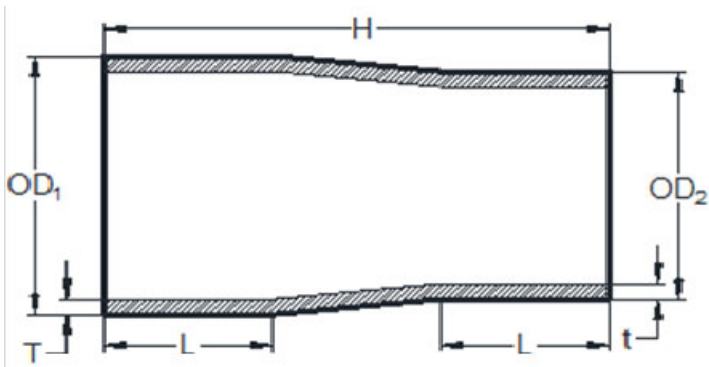

CONCENTRIC REDUCER

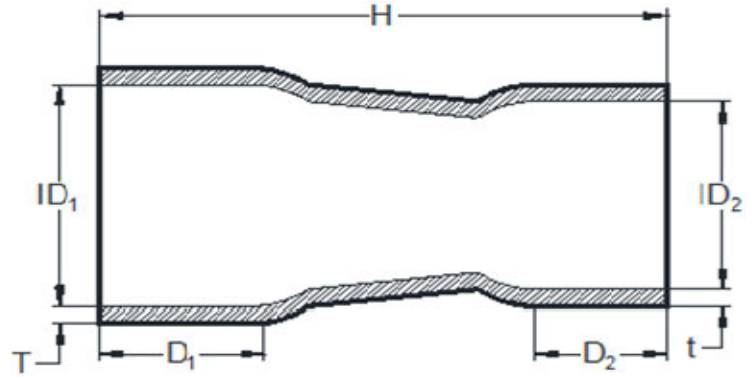

BELLED END CONCENTRIC REDUCER

Nominal Pipe Size	Long Tangent Dimensions				Belled End Dimensions				Schedule 5S		Schedule 10S	
	Outside Dia., OD ₁	Outside Dia., OD ₂	Tang., L	Length, H	Inside Dia., ID ₁	Inside Dia., ID ₂	Bell Depth, D ₁	Bell Depth, D ₂	Nominal Wall, T	Nominal Wall, t	Nominal Wall, T	Nominal Wall, t
6 x 4	6.625	4.500	1.500	9.000	6.625	4.500	1.000	1.000	0.109	0.083	0.134	0.120
6 x 5	6.625	5.563	1.500	9.000	6.625	5.563	1.000	1.000	0.109	0.109	0.134	0.134
8 x 4	8.625	4.500	2.250/ 1.500	9.500	8.625	4.500	1.000	1.000	0.109	0.083	0.148	0.120
8 x 5	8.625	5.563	2.250/ 1.500	9.500	8.625	5.563	1.000	1.000	0.109	0.109	0.148	0.134
8 x 6	8.625	6.625	2.250/ 1.500	9.500	8.625	6.625	1.000	1.000	0.109	0.109	0.148	0.134

Eccentric Reducer Long Tangent and Belled End

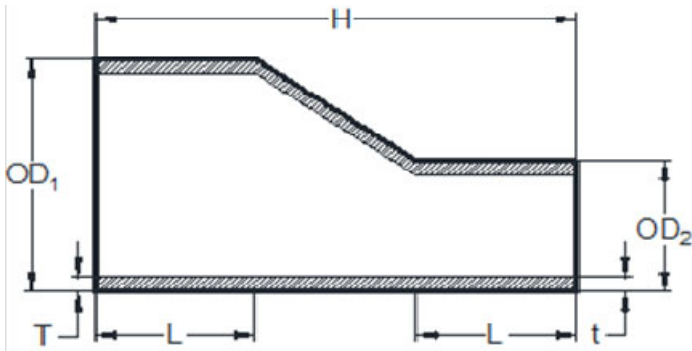

ECCENTRIC REDUCER

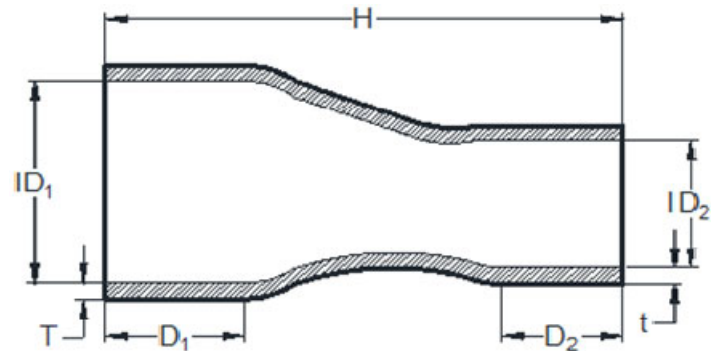

BELLED END ECCENTRIC REDUCER

Nominal Pipe Size	Long Tangent Dimensions				Belled End Dimensions				Schedule 5S		Schedule 10S	
	Outside Dia., OD ₁	Outside Dia., OD ₂	Tang., L	Length, H	Inside Dia., ID ₁	Inside Dia., ID ₂	Bell Depth, D ₁	Bell Depth, D ₂	Nominal Wall, T	Nominal Wall, t	Nominal Wall, T	Nominal Wall, t
¾ x ½	1.050	0.840	0.875	3.375	1.050	0.840	0.625	0.375	0.065	0.065	0.083	0.083
1 x ½	1.315	0.840	0.875	3.375	1.315	0.840	0.625	0.375	0.065	0.065	0.109	0.083
1 x ¾	1.315	1.050	0.875	3.375	1.315	1.050	0.625	0.625	0.065	0.065	0.109	0.083
1 ¼ x ¾	1.660	1.050	0.875	3.375	1.660	1.050	0.750	0.625	0.065	0.065	0.109	0.083
1 ¼ x 1	1.660	1.315	0.875	3.375	1.660	1.315	0.750	0.625	0.065	0.065	0.109	0.109
1 ½ x ¾	1.900	1.050	0.875	3.375	1.900	1.050	0.750	0.625	0.065	0.065	0.109	0.083
1 ½ x 1	1.900	1.315	1.000	3.375	1.900	1.315	0.750	0.625	0.065	0.065	0.109	0.109
1 ½ x 1 ¼	1.900	1.660	1.000	3.375	1.900	1.660	0.750	0.750	0.065	0.065	0.109	0.109
2 x 1	2.375	1.315	1.063	3.375	2.375	1.315	1.000	0.625	0.065	0.065	0.109	0.109
2 x 1 ¼	2.375	1.660	1.063	3.375	2.375	1.660	1.000	0.750	0.065	0.065	0.109	0.109
2 x 1 ½	2.375	1.900	1.063	3.375	2.375	1.900	1.000	0.750	0.065	0.065	0.109	0.109
2 ½ x 1 ¼	2.875	1.660	1.187	5.000	2.875	1.660	1.000	0.750	0.083	0.065	0.120	0.109
2 ½ x 1 ½	2.875	1.900	1.187	5.000	2.875	1.900	1.000	0.750	0.083	0.065	0.120	0.109
2 ½ x 2	2.875	2.375	1.187	5.000	2.875	2.375	1.000	1.000	0.083	0.065	0.120	0.109
3 x 1 ¼	3.500	1.660	1.187	5.000	3.500	1.660	1.000	0.750	0.083	0.065	0.120	0.109
3 x 1 ½	3.500	1.900	1.187	5.000	3.500	1.900	1.000	0.750	0.083	0.065	0.120	0.109
3 x 2	3.500	2.375	1.250	5.000	3.500	2.375	1.000	1.000	0.083	0.065	0.120	0.109
3 x 2 ½	3.500	2.875	1.250	5.000	3.500	2.875	1.000	1.000	0.083	0.083	0.120	0.120
4 x 2	4.500	2.375	1.250	5.000	4.500	2.375	1.000	1.000	0.083	0.065	0.120	0.109
4 x 2 ½	4.500	2.875	1.250	5.000	4.500	2.875	1.000	1.000	0.083	0.083	0.120	0.120
4 x 3	4.500	3.500	1.375	5.000	4.500	3.500	1.000	1.000	0.083	0.083	0.120	0.120
6 x 2 ½	6.625	2.875	1.500	9.000	6.625	2.875	1.000	1.000	0.109	0.083	0.134	0.120
6 x 3	6.625	3.500	1.500	9.000	6.625	3.500	1.000	1.000	0.109	0.083	0.134	0.120
6 x 4	6.625	4.500	1.500	9.000	6.625	4.500	1.000	1.000	0.109	0.083	0.134	0.120
8 x 4	8.625	4.500		9.500	8.625	4.500	1.000	1.000	0.109	0.083	0.148	0.120
8 x 6	8.625	6.625		9.500	8.625	6.625	1.000	1.000	0.109	0.109	0.148	0.134

Aligning Connectors

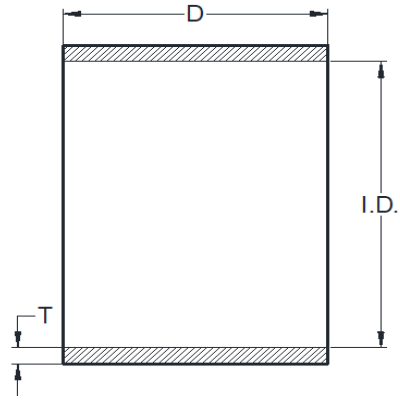

ALIGNING CONNECTOR

Nominal Pipe Size	Inside Diameter, ID	Length, D	Nominal Wall SCH 5S T	Nominal Wall SCH 10S T
½	0.851	1.125	0.065	0.083
¾	1.061	1.125	0.065	0.083
1	1.326	1.250	0.065	0.109
1 ¼	1.676	1.250	0.065	0.109
1 ½	1.918	1.375	0.065	0.109
2	2.393	1.375	0.065	0.109
2 ½	2.895	1.625	0.083	0.120
3	3.525	1.750	0.083	0.120
4	4.525	1.750	0.083	0.120
5	5.585	2.000	0.109	0.134
6	6.625	2.250	0.109	0.134

Long Tangent and Belled End Tolerances

All Fittings				Elbows and Tees	Reducers and Aligning Connectors
Nominal Pipe Size (NPS)	Outside Diameter at Bevel	Inside Diameter at End	Wall Thickness	Center to End Length†	Overall Length†
½ - 2 ½	+ / -.030	+ / -.030	Not Less Than 87 ½ Percent of the Specified Nominal Wall Thickness	+ / -.060	+ / -.060
3 - 3 ½	+ / -.030	+ / -.060		+ / -.060	+ / -.060
4	+ / -.030	+ / -.060		+ / -.060	+ / -.060
5 to 6	+ / -.060	+ / -.060		+ / -.060	+ / -.060

Nominal Pipe Size (NPS)	ANGULARITY TOLERANCE	
	OFF ANGLE	OFF PLANE
½ - 4	+ / -.030	+ / -.060
5-6	+ / -.060	+ / -.125

Depth of Bell on all Belled End Fittings is approximately:

Nominal Pipe Size (NPS)	Depth
½	3/8"
3/4 - 1	5/8"
1 1/4-1 1/2	3/4"
2-6	1"

† Center-to-End and Overall Length for Belled End Fittings is -.125" / + .060"